



## SPECIFICATIONS

### 1 General

Part Number	Description
200M20B55	200MHz crystal filter, DIP package

### 2 Revision History

Revision	Released	Revision Detail
R1	2020-10-28	Initial release

### 3 Electrical Specification

Item	Typical
Nominal Frequency (Fc, MHz)	200
Insertion Loss (dBc)	10.0
Ripple within Pass Band	1.0
Pass Band at -3dB (kHz)	±10
Attenuation (dB, Fc±100kHz)	50
Spurious Response (dB)	-20
Input/ Output Impedance (Ω)	50
Operation Temperature (°C)	-20 ~ +70
Storage Temperature (°C)	-40 ~ +80
Package Size (mm)	30x20x10

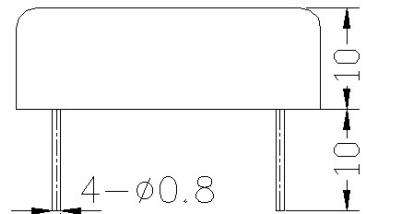

Pin No.	Description
1	Input/Output
2	Output/Input
3,4	Ground

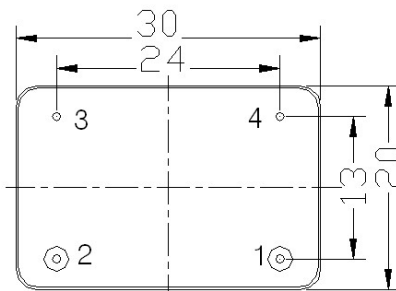

Unit:mm

Bottom View